

# APPLICATION FOR BUILDING AND CONSTRUCTION PERMIT

## PLAQUEMINES PARISH DEPARTMENT OF PERMITS

Port Sulphur, Louisiana 70083

DIST. \_\_\_\_\_

Receipt No. \_\_\_\_\_ BUILDING PERMIT NO. \_\_\_\_\_

ZONING DISTRICT \_\_\_\_\_ Elec. Permit No. \_\_\_\_\_

Date \_\_\_\_\_ Gas Permit No. \_\_\_\_\_

Permit Fee \$ \_\_\_\_\_ Plumb. Permit No. \_\_\_\_\_

Permit Clerk \_\_\_\_\_ Heat Permit No. \_\_\_\_\_

COB \_\_\_\_ Folio \_\_\_\_ Tax Receipt No. \_\_\_\_\_ Refrig. Permit No. \_\_\_\_\_

FIA (FIRM) Zone \_\_\_\_\_ Panel No. \_\_\_\_\_ Required Base Flood Elevation \_\_\_\_\_

OWNER \_\_\_\_\_ ADDRESS \_\_\_\_\_

Phone No. \_\_\_\_\_

SOCIAL SECURITY NO. \_\_\_\_\_

Property Owner \_\_\_\_\_

Project Site \_\_\_\_\_

Directions to Site \_\_\_\_\_

**EXAMPLE  
INFORMATIONAL PURPOSE ONLY  
MUST FILE  
PERMIT  
IN THE OFFICE**

TYPE OF CONSTRUCTION: Residential \_\_\_\_\_ Commercial \_\_\_\_\_ Industrial \_\_\_\_\_ Other \_\_\_\_\_

SPECIFIC PURPOSE: \_\_\_\_\_

\_\_\_\_\_

No. of Persons \_\_\_\_\_ No. Stories \_\_\_\_\_ Bldg \_\_\_\_\_ Ft. Height \_\_\_\_\_ Fence \_\_\_\_\_ Ft. Height \_\_\_\_\_

FOUNDATION GRADE \_\_\_\_\_ FOUNDATION TYPE \_\_\_\_\_ CULVERT SIZE \_\_\_\_\_ PUBLIC SEWER \_\_\_\_\_ SEPTIC TANK \_\_\_\_\_

ROOF TYPE \_\_\_\_\_ ROOF FINISH \_\_\_\_\_ OUTSIDE WALL FINISH \_\_\_\_\_

PROPOSED ELEVATION OF FIRST FLOOR OF BUILDING \_\_\_\_\_

TOTAL SQ. FT. \_\_\_\_\_ CONTRACTOR \_\_\_\_\_

ESTIMATED VALUE \_\_\_\_\_ ADDRESS \_\_\_\_\_

ARCHITECT \_\_\_\_\_

CIVIL ENGINEER \_\_\_\_\_ PHONE NO. \_\_\_\_\_ LICENSE NO. \_\_\_\_\_

I certify that the construction or reconstruction for which this permit is issued, will be in accordance with the Building Code Ordinance No. 15, Ordinance No. 605 as amended, the Plaquemines Parish Flood Plain Management Ordinance, and any other ordinances governing construction or reconstruction of buildings and improvements in the Parish of Plaquemines. The undersigned acknowledges that this permit does not authorize construction or placement contrary to existing title restrictions or the Parish Zoning Ordinance No. 142.

**EXAMPLE**

**INFORMATIONAL PURPOSE ONLY**

APPROVED \_\_\_\_\_ DATE \_\_\_\_\_ OWNER OR AGENT \_\_\_\_\_

ANNEX "A" MUST BE COMPLETED BEFORE THIS APPLICATION WILL BE CONSIDERED.

PLEASE READ CAREFULLY THE IMPORTANT NOTES ON THE REVERSE SIDE OF THIS SHEET.

NOTE: THIS PERMIT WILL EXPIRE ONE (1) YEAR FROM THE DATE APPROVED.

**ANNEX "A"**

OWNER \_\_\_\_\_ BUILDING PERMIT NO. \_\_\_\_\_

IS THIS A CORNER LOT?     YES     NO                      DATE \_\_\_\_\_

DRAW PLOT PLAN: A separate application must be made for each proposed structure. Include all existing structures along with proposed structure. If commercial or industrial, designate proposed parking area and loading area.

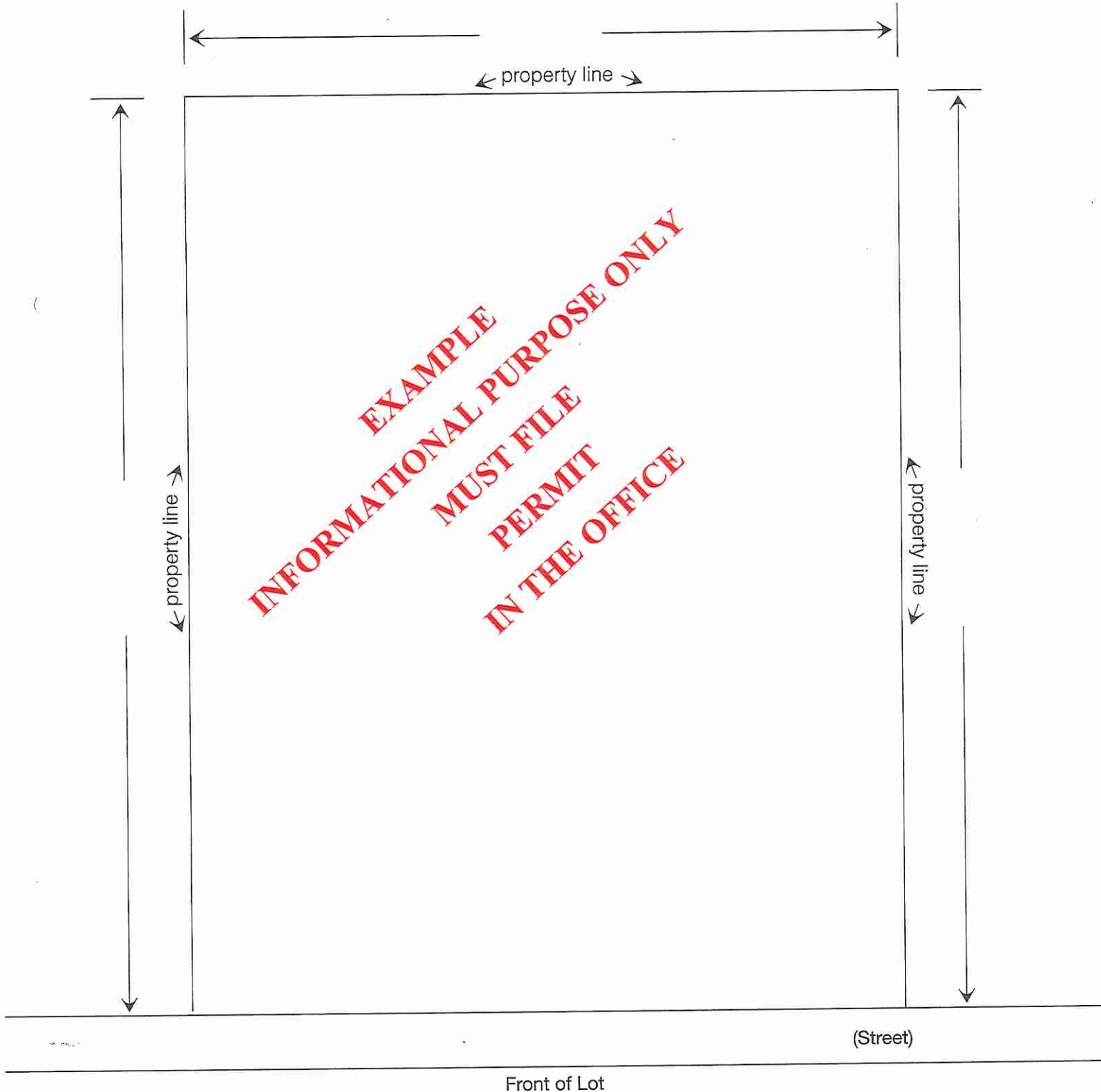

**EXAMPLE**  
**INFORMATIONAL PURPOSE ONLY**

Approved \_\_\_\_\_ Date \_\_\_\_\_ Owner or Agent \_\_\_\_\_

NOTE: Permit for Building and Construction will expire one (1) year from date of approval.  
Permit for trailer/mobile home will expire six (6) months from date of approval.