

# APPLICATION FOR BUILDING PERMIT – TRAILER / MOBILE HOME

## PLAQUEMINES PARISH DEPARTMENT OF PERMITS

DIST. \_\_\_\_\_

Port Sulphur, Louisiana 70083

Receipt No. \_\_\_\_\_

BUILDING PERMIT NO. \_\_\_\_\_

ZONING DISTRICT \_\_\_\_\_

Elec. Permit No. \_\_\_\_\_

Date \_\_\_\_\_

Gas Permit No. \_\_\_\_\_

Permit Fee \$ \_\_\_\_\_

Plumb. Permit No. \_\_\_\_\_

Permit Clerk \_\_\_\_\_

Heat. Permit No. \_\_\_\_\_

COB \_\_\_\_\_ Folio \_\_\_\_\_ Tax Receipt No. \_\_\_\_\_

Refrig. Permit No. \_\_\_\_\_

FIA (FIRM) Zone \_\_\_\_\_ Panel No. \_\_\_\_\_

Required Base Flood Elevation \_\_\_\_\_

OWNER \_\_\_\_\_

ADDRESS \_\_\_\_\_

Phone No. \_\_\_\_\_

SOCIAL SECURITY NO. \_\_\_\_\_

Property Owner \_\_\_\_\_

Project Site \_\_\_\_\_

Direction to Site \_\_\_\_\_

TYPE OF CONSTRUCTION: Residential \_\_\_\_\_ Commercial \_\_\_\_\_ Industrial \_\_\_\_\_ Other \_\_\_\_\_

SPECIFIC PURPOSE: \_\_\_\_\_

FOUNDATION GRADE \_\_\_\_\_

FOUNDATION TYPE \_\_\_\_\_

CULVERT SIZE \_\_\_\_\_

PUBLIC SEWER \_\_\_\_\_

SEPTIC TANK \_\_\_\_\_

ROOF TYPE \_\_\_\_\_

ROOF FINISH \_\_\_\_\_

OUTSIDE WALL FINISH \_\_\_\_\_

PROPOSED ELEVATION OF FIRST FLOOR OF BUILDING \_\_\_\_\_

TRAILER STICKER NO. \_\_\_\_\_

MAKE OF TRAILER \_\_\_\_\_

YEAR \_\_\_\_\_

SERIAL NO. \_\_\_\_\_

TOTAL SQ. FT \_\_\_\_\_

ESTIMATE VALUE \_\_\_\_\_

TRAILER PURCHASED FROM: \_\_\_\_\_

COLOR \_\_\_\_\_

LAND ON WHICH TRAILER IS LOCATED: OWNED  RENTED

### NOTICE

**THIS PERMIT IS TEMPORARY.** Compliance with Ordinance No.111, as amended, and Ordinance No. 605, as amended, will be absolutely necessary whenever inspected by this Department.

Trailer/Mobile Home must be placed at the above project site within six (6) months from date of approval or this permit will become null and void.

I certify that the construction or reconstruction for which this permit is issued, will be in accordance with Ordinance No. 111, the Plaquemines Parish Mobile Home Parks, Trailer Courts or Camps Ordinance, Ordinance No. 605, as amended, the Plaquemines Parish Flood Plain Management Ordinance, and any other ordinances governing construction or reconstruction of building and improvements in the Parish of Plaquemines. The undersigned acknowledges that this permit does not authorize construction or placement contrary to existing title restrictions or the Parish Zoning Ordinance No. 142.

**EXAMPLE**

**INFORMATIONAL PURPOSE ONLY**

APPROVED \_\_\_\_\_

DATE \_\_\_\_\_

OWNER OR AGENT \_\_\_\_\_

ANNEX "A" MUST BE COMPLETE BEFORE THIS APPLICATION WILL BE CONSIDERED.  
PLEASE READ CAREFULLY THE IMPORTANT NOTES ON THE REVERSE SIDE OF THIS SHEET.

**ANNEX "A"**

OWNER \_\_\_\_\_ BUILDING PERMIT NO. \_\_\_\_\_

IS THIS A CORNER LOT?     YES     NO    DATE \_\_\_\_\_

DRAW PLOT PLAN: A separate application must be made for each proposed structure. Include all existing structures along with proposed structure. If commercial or industrial, designate proposed parking area and loading area.

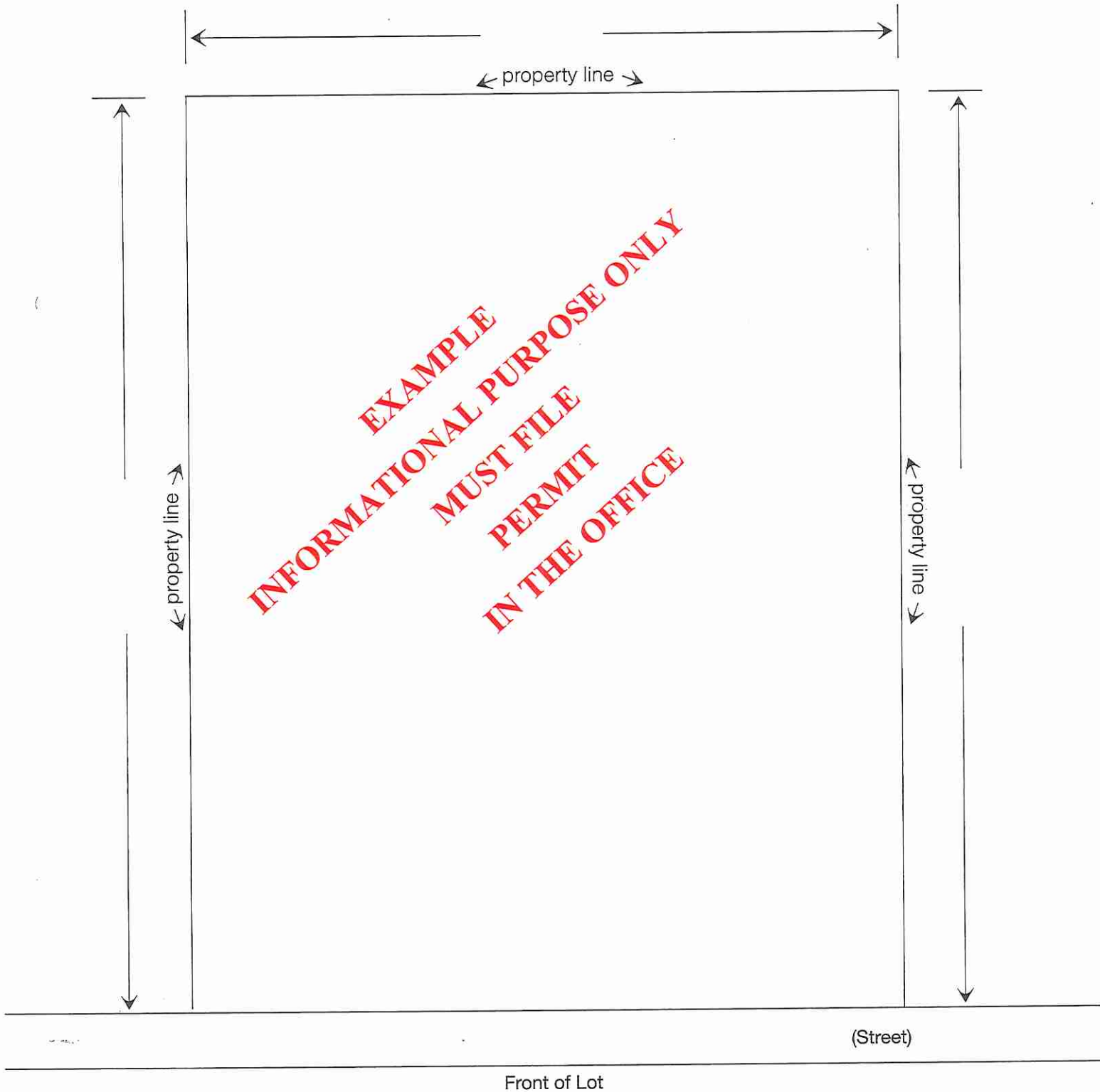

**EXAMPLE**

**INFORMATIONAL PURPOSE ONLY**

Approved \_\_\_\_\_

Date \_\_\_\_\_

Owner or Agent \_\_\_\_\_

NOTE: Permit for Building and Construction will expire one (1) year from date of approval.  
Permit for trailer/mobile home will expire six (6) months from date of approval.